

*To arrange a viewing contact us
today on 01268 777400*



Welling Road, Orsett Guide price £525,000

Aspire Estate Agents are delighted to introduce this spacious and immaculately presented four-bedroom detached family home, ideally located in the highly desirable area of Orsett. Offering a generous internal layout, ample off-street parking, and a private garage, this home is perfectly suited to growing families seeking both comfort and convenience in a well-connected location.

Set behind a large driveway with space for 4–5 vehicles, the home welcomes you with an impressive sense of space and flexibility. Inside, you'll find three substantial reception areas, offering multiple options for family living, entertaining, or even home working. Whether you're hosting guests or enjoying quiet evenings in, there's room for everyone to relax in comfort.

At the heart of the home lies a well-proportioned kitchen, offering plenty of worktop and storage space, with ample room for appliances and casual dining. A convenient ground-floor cloakroom adds everyday practicality.

Upstairs, the property continues to impress with four generously sized double bedrooms. The primary bedroom features its own en-suite, while the remaining rooms are served by a modern family bathroom—perfectly designed for busy households.

This fantastic home is ideally positioned for access to some of the area's most highly rated schools, many of which boast outstanding Ofsted ratings, making it an ideal choice for families prioritising education. For commuters, the property is extremely well connected, with excellent road and public transport links offering direct routes into London. In addition, the popular Lakeside Shopping Centre is just a short drive away, providing a wide range of retail, dining, and leisure options.

This is a truly versatile home that combines spacious living with a prime location—a rare opportunity not to be missed.

LOUNGE

23'1 x 13'4 (7.04m x 4.06m)

KITCHEN

11'8 x 11'8 (3.56m x 3.56m)

DINING ROOM

11'8 x 11'1 (3.56m x 3.38m)

W/C

CONSERVATORY

32'3 x 12'0 (9.83m x 3.66m)

LANDING

BEDROOM ONE

13'9 x 12'7 (4.19m x 3.84m)

EN SUITE

BEDROOM TWO

11'10 x 10'9 (3.61m x 3.28m)

BEDROOM THREE

10'9 x 10'4 (3.28m x 3.15m)

BEDROOM FOUR

9'7 x 7'5 (2.92m x 2.26m)

FAMILY BATHROOM

GARAGE

17'1 x 8'11 (5.21m x 2.72m)

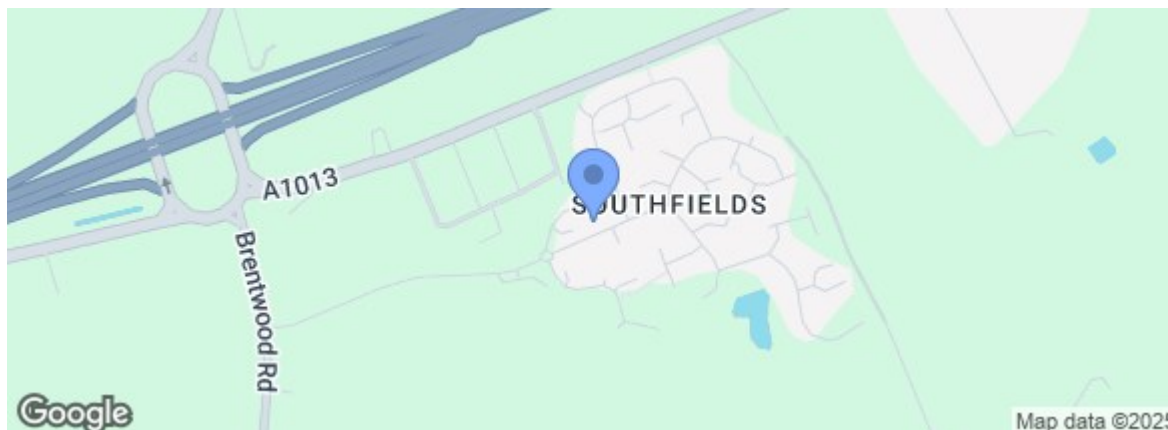
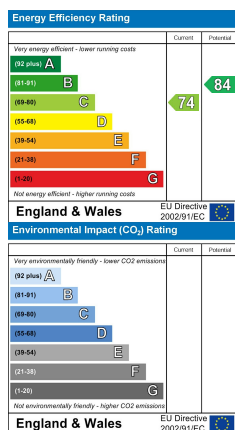
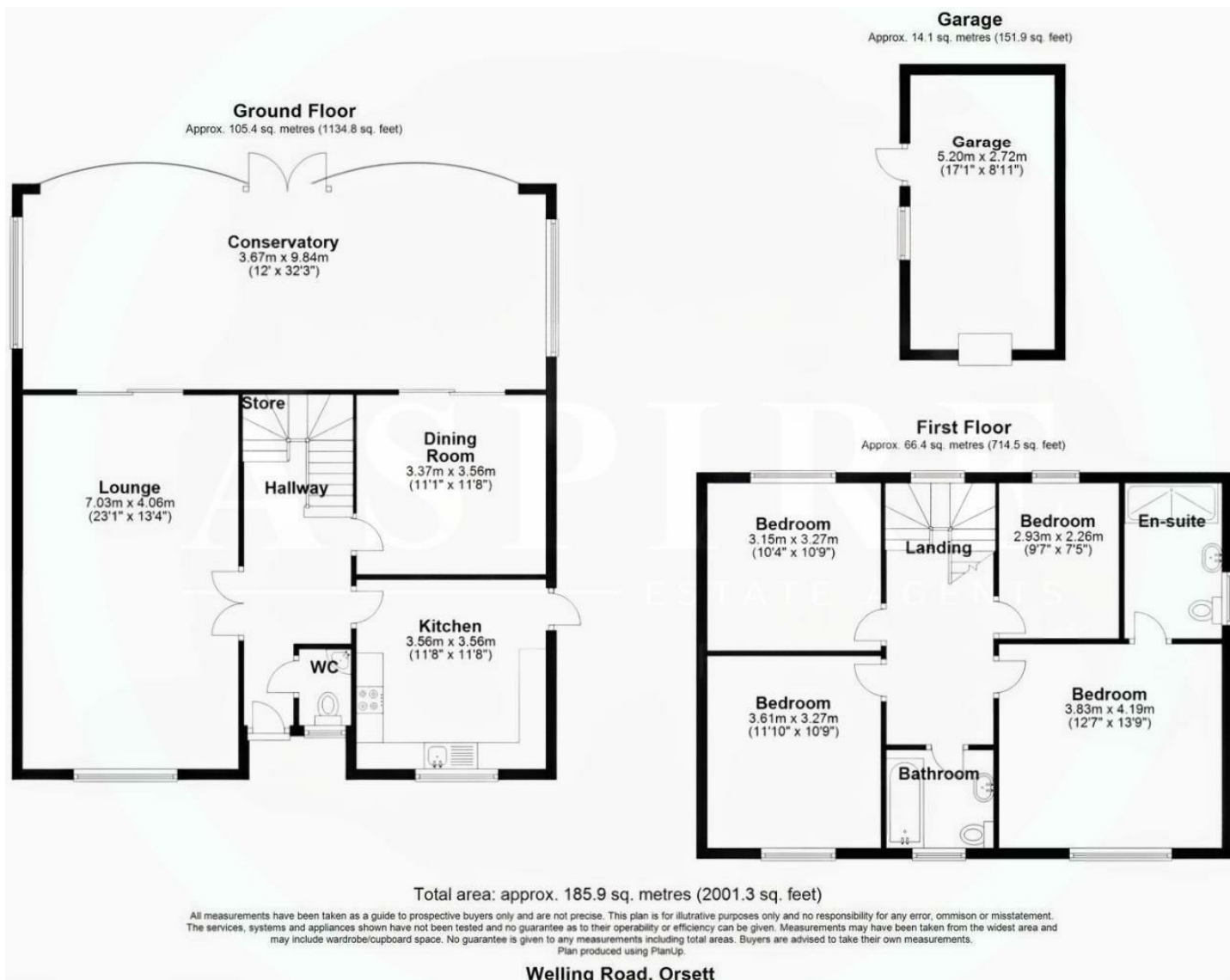

rightmove.co.uk
The UK's number one property website

Zoopla.co.uk

Under the Property Misdescriptions Act 1991 we make every effort to ensure our sales details are accurate but they are a general outline and do not constitute any part of an offer or contract. Any services, equipment and fittings have not been tested and no warranty can be given as to their condition. We strongly recommend that all the information provided be verified by your advisors and in particular, measurements required for a specific purpose such as fitted furniture or carpets. Please tell us if you have any problems and members of our branches will help either over the phone or in person. A copy of our complaints procedure is available on request. The details are issued on the strict understanding that any negotiations in respect of the property named herein are conducted through Aspire Estate Agents.